

## Flush Diaphragm Pressure Gauges for Food , Biological and Pharmaceutical Industry Model MBS10B+DD1222

### Applications

- Dry measuring cell, no transmission liquid
- Wetted parts and covering metallic components made of stainless steel
- Hygienic-type connection for direct, fast installation and removal
- Suitable for CIP-facilities
- Scale ranges from 0 ... 0.6 bar to -1 ... 16 bar

### General features

The pressure gauge model MBS10B was designed as an addition to DMASS's standard range of products in order to meet the special demands made on process connections in the food, biological and pharmaceutical industry as well as in the paint and lacquer sector.

All wetted parts are made of stainless steel and fully welded.

Due to the special design of the gauge it is possible to use an absolutely dry measuring cell, thus excluding a contamination of the medium with transmission liquids that may occur on diaphragm seal systems in the case of a damage to the diaphragm.



### Standard features

#### Design

EN 837-3

#### Nominal size

100 and 160 mm

#### Accuracy class per EN 837-3 /6

1.6

#### Working pressure

Steady: full scale value

Fluctuating: 0.9 x full scale value

#### Overpressure safety

1.5 x full scale value

#### Operating temperature

Ambient: -20 ... +60 °C

Medium: +150 °C maximum

#### Temperature effect

When temperature of the pressure element deviates from reference temperature (+20 °C):

max. ±0.8 %/10 K of true scale value

#### Ingress protection

IP 54 per EN 60 529 / IEC 529

#### Process connection (exposed to pressure medium)

Stainless steel 316L, 1½", 2" clamp, bottom connection

#### Pressure element (exposed to pressure medium)

Welded with process connection, stainless steel 316L

#### Movement

Material: stainless steel

#### Dial

White aluminium with black lettering

#### Pointer

Black aluminium pointer

#### Case

Stainless steel case with pressure vent in case back

#### Window

Laminated safety glass

#### Bezel ring

Cam ring (bayonet type), stainless steel

## Dimensions

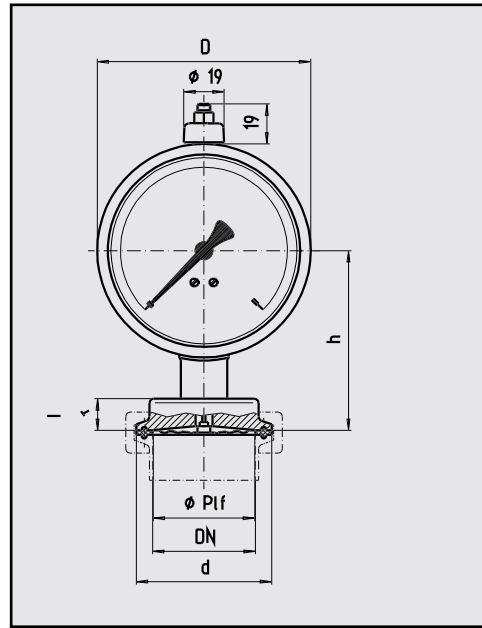

### Clamp connection

Process connection	DN [in.]	Dimensions [mm]						Weight [kg]
		D	h	Ø P1f	G	d	k	
Clamp	1 ½	100	85	39	-	50.5	45	0.45
		160	115		-			0.8
	2	100	85		-	64	45	0.65
		160	115		-			1.05
	2 ½	100	85		-	77.5	45	0.85
		160	115		-			1.25